

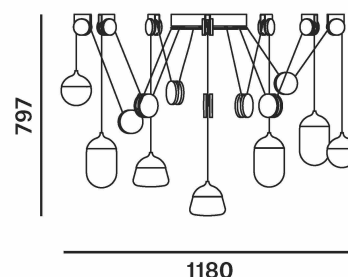

## Description

The Planets collection stands out with its remarkable versatility, offering a broader dimension in interior lighting with installations ranging from a single light to vast clouds of up to twelve lights. The Planets family has been expanded with a new version called Planets MINI.



## Tech. description

The light is hung from a central metal ceiling canopy, which houses the electronics. The individual lights are hung from the ceiling by means of pulleys and balanced with counterweights. The system allows variable vertical positioning of each light independently. Each light comprises a power cable, metal cover, LED module, and a glass shade.

Available colour options: <https://mbapi.cz/red/pis/eu/en/pc1365>

## CONSTRUCTION SPECIFICATION

Weight:	25,5 kg
Construction material:	glass, metal
Cord length [mm]:	individual
Mounting:	Ceiling
Environment:	Indoor

## DIMENSIONS [mm]

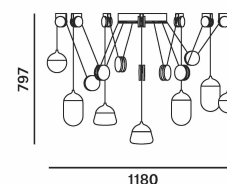

## ELECTRICAL SPECIFICATION

Input voltage [V]:	110 - 240 V
Frequency [Hz]:	50-60 Hz
Max. power [W]:	61 W LED
Coverage IP:	20
Socket:	-
Light source:	LED module
Energy class:	E

## CERTIFICATIONS





CM16714 BAMBOO LED module -  
D55mm/6,5W/1CH/2700K/Ra90

Type	LED module
Lamp wattage [W]	6.5 W
Input voltage [V]	24 VDC
Energy class	E
Flux [lm]	735 lm
Light colour [K]	2700 K
CRI	90+
Dimmable	yes



CM17129 BAMBOO LED modul -  
D55mm/6,5W/2CH LUXEON/180hm/  
1800K/6500K/Ra90

Type	LED module
Lamp wattage [W]	6.5 W
Input voltage [V]	24 VDC
Energy class	E
Flux [lm]	735 lm
Light colour [K]	1800-6500 K
CRI	90+
Dimmable	yes





### INNER FIXTURE

Dimensions O x w [mm]	300 X 59
Weight [kg]	5.2
Material	metal

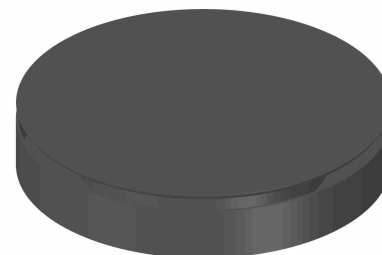

### Drawing

### Hole placement

