



Description

The endless variability of the Puro collection designed by Lucie Koldova has given rise to the new suspension light called Sparkle. This amazing lighting object shines with noble yet minimalistic geometry and constitutes the centrepiece of any space. The multiple tubes of matt opal or smoke grey glass radiate outward in diffuse light for a magical interior ambience and dynamic. Sparkle levitates in space and dominates its interior landscape. It is a light sculpture and the embodiment of positive energy. The Puro Sparkle comes in 3 sizes and the largest composition creates an amazing lighting object reaching almost a diameter of 2,5 m.



Tech. description

Puro Sparkle comprises twelve Puro light tubes arranged in a three-dimensional star formation. The tubes are suspended from the outside by wire ropes anchored directly to the ceiling and from the inside by the power cable, which is secured in the central ceiling canopy. The ceiling canopy also houses the electronics, which are accessible through a service door in the side of the canopy. The tubes are wired to the power cable with special BROKIS connectors.

Available colour options: <https://mbapi.cz/red/pis/eu/en/pc1053>

CONSTRUCTION SPECIFICATION

| | |
|------------------------|---------------|
| Weight: | 30.5 kg |
| Construction material: | glass, metal |
| Cord length [mm]: | max. 6,000 mm |
| Mounting: | Ceiling |
| Environment: | Indoor |

DIMENSIONS [mm]

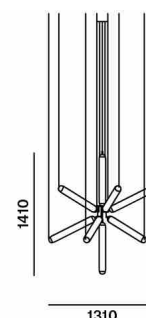

ELECTRICAL SPECIFICATION

| | |
|--------------------|---------------------------------|
| Input voltage [V]: | 100 - 240 V |
| Frequency [Hz]: | 50-60 Hz |
| Max. power [W]: | 156 W LED |
| Coverage IP: | 20 |
| Socket: | - |
| Light source: | non-user replaceable LED module |
| Energy class: | E |

CERTIFICATIONS



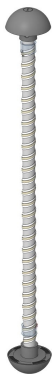

**CP12211 Puro SPARKLE vertical
assembly SAMSUNG LED 600mm 927
black**

| | |
|-------------------|------------|
| Type | LED module |
| Lamp wattage [W] | 13 W |
| Input voltage [V] | 24 VDC |
| Energy class | E |
| Flux [lm] | 1105 lm |
| Light colour [K] | 2700 K |
| CRI | 80+ |
| Lifespan [h] | 20000h |
| Dimmable | yes (PWM) |

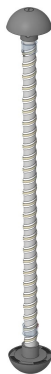

**CP12213 Puro SPARKLE vertical
assembly SAMSUNG LED 600mm 940
black**

| | |
|-------------------|------------|
| Type | LED module |
| Lamp wattage [W] | 13 W |
| Input voltage [V] | 24 VDC |
| Energy class | E |
| Flux [lm] | 1224 lm |
| Light colour [K] | 4000 K |
| CRI | 80+ |
| Lifespan [h] | 20000h |
| Dimmable | yes (PWM) |



**CP12215 Puro SPARKLE vertical
assembly SAMSUNG LED 600mm 950
black**

| | |
|-------------------|------------|
| Type | LED module |
| Lamp wattage [W] | 13 W |
| Input voltage [V] | 24 VDC |
| Energy class | E |
| Flux [lm] | 1309 lm |
| Light colour [K] | 5000 K |
| CRI | 80+ |
| Lifespan [h] | 20000h |
| Dimmable | yes (PWM) |



INNER FIXTURE

| | |
|-----------------------|-------------|
| Dimensions O x w [mm] | 400 x 70 mm |
| Weight [kg] | 3.5 kg |
| Material | metal |

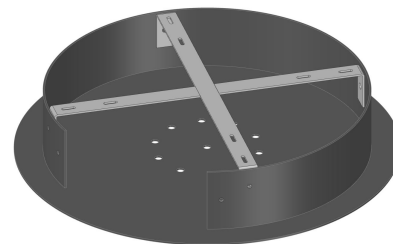

Drawing

Hole placement

