

## Wally Cestita

Miguel Milá. 1962

Wall lamp

  
SANTA & COLE



European version

American version

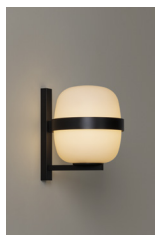

Designed in the same year as the Cesta lamps, Wally is an iconic wall lamp that shares the same opal globe shape and formal elegance. The structure, available in both matte white and matte black finishes, is fixed to the wall via a metal arm and ring that wrap around and support the glass shade.

The Wally Cestita wall lamp adds a distinguishing touch to any setting. It provides a diffuse and soft illumination for both indoor and outdoor spaces.

### General description:

Matte metallic structure finished in black or white grey.

White opal glass lampshade.

Suitable for Outlet Box (American version).

### Approximate weight (unpacked):

1,5 Kg / 3.3 lb

### Technical information:

European version: Light source included

American version: Recommended light source (not included)

LED bulb: 3,4 W / 470 lm / 2700K

E27 - E26 / Max. hgt. 105 mm / 4.1"

Suitable for outdoor use (european version).

Always use the light source recommended or equivalent.

Input voltage: 100, 120, 230 Vac.

(50 Hz / 60 Hz). According to destination

### Regulations:

European version

UNE-EN 60598

UNE-EN 55015

UNE-EN 60529

American version

Damp location

UL-1598

E-353545

# Wally Cestita

Miguel Milá. 1962  
Wall lamp

  
SANTA & COLE

## Maintenance:

Clean with a smooth cloth. Do not use ammonia, solvents or abrasive cleaning products.

## Others:

The lamp is delivered in one package.  
The assembly instructions are delivered with the product.

## Model (European version):

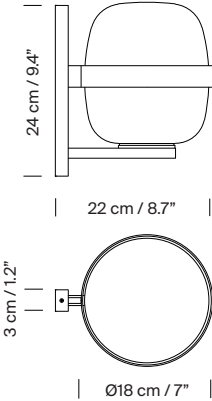

## Model (American version):

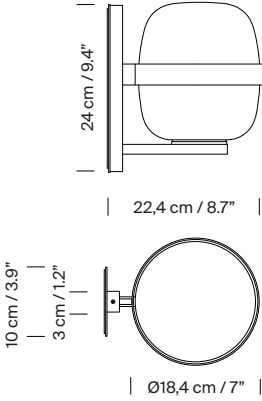

## Collection:

Table lamps



Cesta



Cestita



Cesta Batería



Cesta Metálica



Cestita Metálica

## Pendant lamps



Globo Cesta



Globo Cestita



Wally Cesta



Wally Cestita



Cesta exterior



Cestita Alubat

## Wall lamps (Outdoor)

## Outdoor lamps